



COLOUR CODED GRADE 'S' BOW SHACKLE BUCKET

Our unique colour coded design,
makes it safe and easy to match components.

Screw Pin Bow Shackles

Capacities: 1 to 8.5 tonne

Beaver continue to offer the widest possible choice of shackles.

Our colour coded shackles take the guess work out of choosing the right capacity when matching lifting components.

All Beaver Grade 'S' shackles are easily identified with prominent stamping indicating MM/YY for quick reference of the products manufacture and working load limit.

Suitable for mining, resource and construction industry applications.

When safety counts - make the right choice first time with a Beaver colour coded product.

Complies to AS2741-2002.



As of 01/01/2014 Shackles from 0.33T to 8.5T will only be available to purchase in buckets.





COLOUR CODED GRADE 'S' BOW SHACKLE BUCKET

Technical Data

- Beaver Alloy Grade 'S' colour coded shackles have been developed in accordance with Australian Standard AS2741-2002.
- Shackles in this range are easily identified and traceable within Beaver's quality assurance system.
- Test certificates are readily available on request.

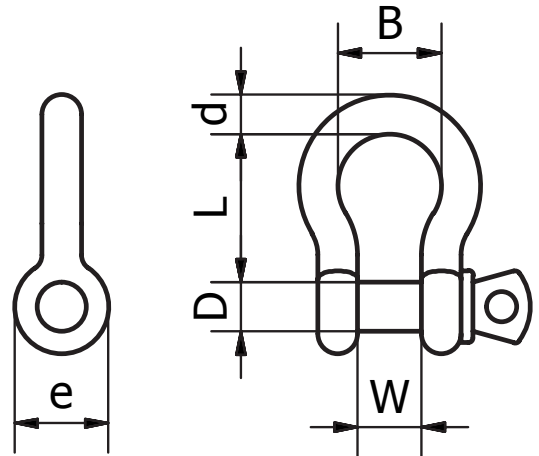
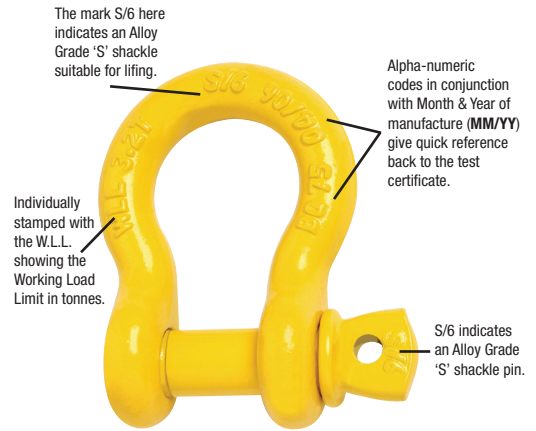

Screw Pin Bow Shackles - SPECIFICATIONS & DIMENSIONS

| Beaver Code | Size mm | Working Load Limit tonnes | Shackle Colour | Dia. d mm | Pin Dia. D mm | Inside Width W mm | Inside Length L mm | Dia. Boss e mm | Width of Bow B mm | Approx. Weight each kg | Square Pail | Qty / Pail | Weight / Pail |
|-------------|---------|---------------------------|----------------|-----------|---------------|-------------------|--------------------|----------------|-------------------|------------------------|-------------|------------|---------------|
| 242310MP | 10 x 11 | 1.00 | Violet | 10 | 11 | 17 | 37 | 25 | 26 | 0.15 | 2L | 30 | 4.23 |
| 242313MP | 13 x 16 | 2.00 | Green | 13 | 16 | 21 | 48 | 33 | 33 | 0.37 | 2L | 14 | 4.62 |
| 242316MP | 16 x 19 | 3.20 | Yellow | 16 | 19 | 27 | 61 | 40 | 43 | 0.65 | 5L | 20 | 12.40 |
| 242319MP | 19 x 22 | 4.70 | Grey | 19 | 22 | 32 | 72 | 48 | 51 | 1.06 | 5L | 10 | 10.70 |
| 242322MP | 22 x 25 | 6.50 | Brown | 22 | 25 | 37 | 84 | 54 | 58 | 1.56 | 5L | 8 | 13.12 |
| 242325MP | 25 x 29 | 8.50 | Blue | 25 | 29 | 43 | 95 | 60 | 68 | 2.32 | 5L | 4 | 9.20 |

NOTE : Dimensions are nominal - actual dimensions fall within the tolerances of AS2741-2002.



Beaver Testing Facilities

Beaver is a company with AS/NZS ISO 9001:2008 Quality Assurance accreditation and NATA Accredited Laboratories are our commitment to supply a quality product and service to our customers is most important to us.

We have NATA Test Laboratories located in Sydney and Perth.

Specifications and dimensions subject to change without notice.
© Copyright 2013 Beaver Brands B0C-SA-04-SHK-C/R



Distributed by: